

DRY AGING CASE

REFRIGERATED CASE FOR DRY AGING MEAT

GBS

FOODSERVICE EQUIPMENT INC.

Standard construction features

- Stainless steel construction (430 exterior, 316 interior)
- Glass doors
- Pink LED lighting
- Lockable doors for access control
- Removable parts for easy cleaning
- Electronic management system of the aging conditions
- Temperature, ventilation and humidity manager
- Alarm system

Options

- 3 standard sizes :
 - 24 x 30 x 79
 - 48 x 30 x 79
 - 72 x 30 x 79
- Side window available
- Wheel kit
- Different color choices
- Custom fabrication available

THE
MEAT
LOCKER



****48 inch model**

GBS

FOODSERVICE EQUIPMENT INC.

2871 Brighton Road Oakville, Ontario
L6H 6C9, Canada
Phone: 905.829.5534 / Toll Free: 888.402.1242
www.gbscooks.com

SPECIFICATIONS

| Size | Electricity | Aging capacity |
|-----------|---------------------|--------------------------|
| 24 inches | 120V 20A 60Hz | 220 lbs (10 meat pieces) |
| 48 inches | 120V/240V 20A 60 Hz | 440 lbs (20 meat pieces) |
| 72 inches | 120V/240V 20A 60 Hz | 660 lbs (30 meat pieces) |

DIMENSIONS

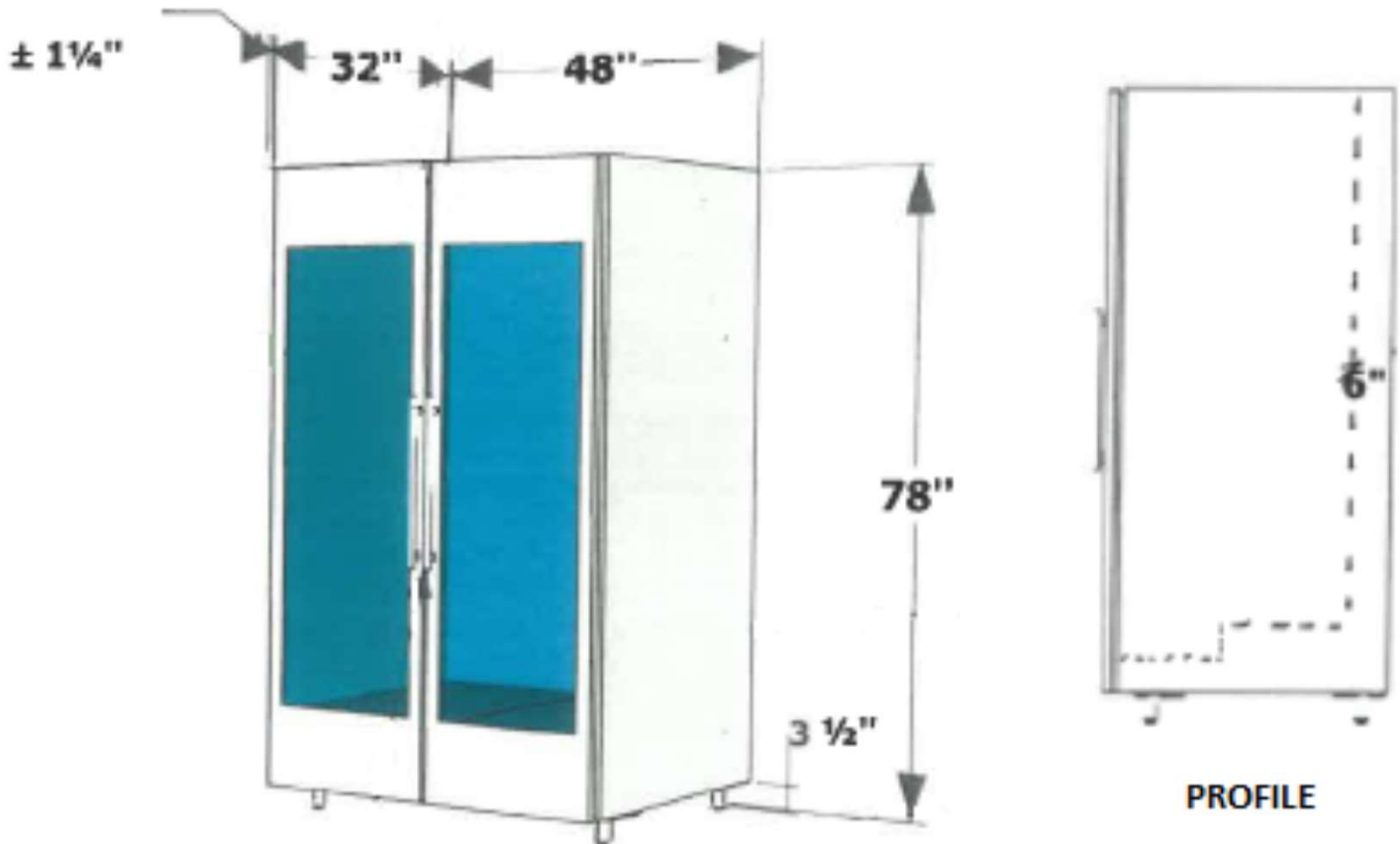

**48 inch model

**Blue window for representation purposes